



Catalyst for synergetic living

Terra
greens 

The gateway of Rajasthan



Bhiwadi is located at the east end of Rajasthan in Tijara Tehsil of Alwar District. A flourishing industrial town, Bhiwadi is among the fastest-growing cities of India and fast becoming a preferred haven for real estate developers. The city-in-the-making is already a preferred residential suburb for MNCs and industrial complexes in Manesar and Dharuhera.

The Rajasthan Housing Board has contributed immensely by creating the necessary infrastructure by way of schools, hospitals, banks, transportation, water supply and telecommunications networks.

Location

40 minutes from IGI Airport, New Delhi

30 minutes from Gurgaon
on four-lane express highway

In the heart of Bhiwadi

Gated and secure complex

75% Green and open

Water bodies & landscaped areas

Healthcare & educational
institutions in the vicinity

The Project

Creating soulful spaces



Terra Greens has been conceived keeping in mind the complex's utility, creative essence and expression in mind. It offers a harmonious blend of scientific space management with modern urban living.

The two-side open apartments are aesthetically designed for modern day living facilitating the free flow of air and natural light into each room helping conserve precious energy.

2 & 3 BHK apartments

Ground + 9 floors (2 BHK apartments)

Ground + 4 floors (3 BHK apartments)

Well ventilated rooms

Vastu compliant layout

Optimum space management

Neo rich specifications

Designed for a stress-free living

Club

Fully equipped gymnasium

Walking track

Meditation Park

Recreation

Kids play area

Convenience Store

Treat your business guests on a leisure day

Site Plan

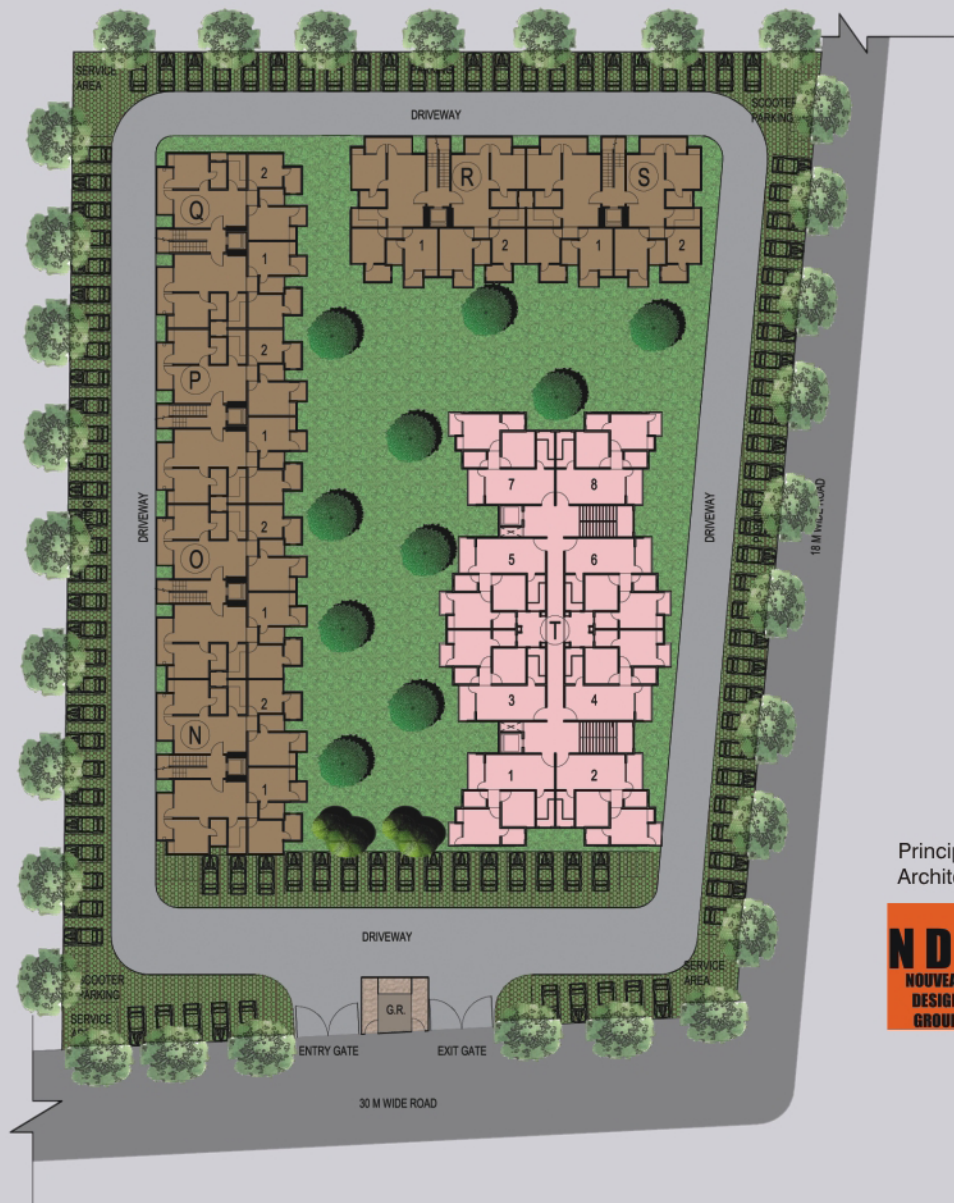

Principal
Architect



Built to stand
the test of time

24 x 7 water supply

24-hour power back-up for
essential services

Fully automatic lifts

Dedicated space for parking



Specifications

Structure	:	Earthquake Resistant
Drawing / Dining	:	Vitrified Tiles
Master Bedroom	:	Laminated Wooden Flooring
Bedroom	:	Vitrified Tiles
KITCHEN		
Flooring	:	Ceramic Tiles
Walls	:	Tiles up to 2' height
Counter	:	Granite Counter with Stainless Steel Sink
TOILETS		
Flooring	:	Anti-skid Tiles
Walls	:	Ceramic Glazed Tiles up to 7' height
Fittings & Fixtures	:	Mirror, Provision for Hot and Cold Water Supply Systems
C.P. Fitting	:	Jaquar / equivalent
Balcony	:	Anti-skid Tiles
Wall Finish	:	Oil Bound Distemper with POP Cornish
Doors and Windows	:	Window - Aluminium Door - Moulded Skin Doors Main Door - Frame of Teak with moulded Panel Door
External Finish	:	Permanent Texture / Paint finish
Electrical	:	Copper Concealed Wiring + Modular Switches
Lift Lobby & Staircase	:	Decorative Marble



Unit Plans



Blissful modern living

Terra Greens is a gated residential complex coming up at an unparalleled location in the vibrant city of Bhiwadi. The open and spacious surroundings are a welcome change from the city's congestions. Built in harmony with nature, the environment contributes to the well-being of your family physically and mentally. Conducive to the community living concept of togetherness, the project is governed by all what it takes to lead fulfilling lives without compromising on fine living.

Terra
greens



TERRA REALCON PVT. LTD.

118, First Floor, Vipul Agora, MG Road

Gurgaon - 122 002, Haryana

T. +91 124 4276130-31 | F. +91 124 4276136

E. info@terragroup.co.in

www.terragroup.co.in

Note: This brochure is purely conceptual and not a legal offering. The developer reserves the right to amend / alter the area, layout, elevations, specifications and amenities. Elevations used in the brochure are purely artistic impressions and tend to change with / without prior notice.

1 sq. mtr. = 10.764 sq. ft.

Member of

